

TAKE-UP DEVICES-ALLOWABLE STRENGTH DESIGN

Model Number	Rod Diameter (Max.)	Matl.	Dimensions (Inches)		Rated Take-Up (Inches)	Allowable Load Pounds	Δ_R (inches) Seating Increment	Δ_A (inches) Deflection at Allowable Load
			O.D.	H				
AT4A-1.5	1/2"	Aluminum	1-1/2	3.00	1.50	6,450	0.000*	0.011
AT4A-2.5				4.06	2.50			
AT6A-1.5	3/4"		2-1/8	3.19	1.50	10,550	0.000*	0.011
AT6A-2.5				4.19	2.50			
AT8A-1.5	1"		2-3/4	3.50	1.75	20,750	0.000*	0.004
AT10A-1.5	1-1/4"		3-1/4	3.50	1.62	28,050	0.000*	0.021
AT12A-1.5	1-1/2"		3-1/4	3.50	1.62	28,050	0.000*	0.021
AT16A-2.0	2"		4	3.50	2.07	39,450	0.001*	0.011
AT 75	3/4"	Steel	2	2.80	1.10	16,450	0.002	0.024
AT 75-2.5				4.00	2.50	15,200		0.021
AT 100	1"		2-1/4	2.90	1.10	25,300	0.032	
AT 125	1-1/4"		2-3/4	2.86	1.10	34,500	0.016	
AT 200-2.0	2"		4	3.88	2.18	83,200	0.000*	0.009

New
New
New
New

* Δ_R is Less than 0.0005"
-See ICC-ESR 1344 for latest capacities



AT A GLANCE		
CAPACITY	Δ_A	Δ_R
Take-Up Devices are designed to accommodate high differential loads.	Multi-Lead thread design provides unmatched reliability in harsh jobsite conditions	AutoTight® Provides TUDs with the lowest operating looseness

Copyright 2020 Commins Manufacturing Inc

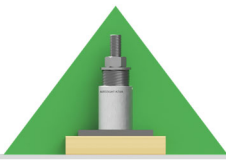





TAKE-UP DEVICES

TAKE-UP DEVICE INSTALLATION

Take-Up Device installation is simple. The following illustrations show the proper sequence for correctly installing the Automatic Take-Up Device



 STEP 1 THREADED ROD	 STEP 2 BEARING PLATE	 STEP 3 TAKE-UP DEVICE	 STEP 4 NUT & WASHER
<p>Threaded rods must be installed plumb.</p> <p>Rods may not exceed an out-of-plumb condition of 2" per 10'-0".</p>	<p>Bearing plates are sized to fit 2x4 or 2x6 walls</p> <p>All bearing plates have oversized holes to ensure alignment.</p>	<p>Slide the TUD over the rod and onto the bearing plate</p> <p>Rotate the TUD so the activation pin is accessible</p>	<p>Slide the washer down the threaded rod until it sits flat on top the TUD</p> <p>Thread the Hex nut to the washer and finger tighten</p>



STEP 5

ACTIVATION INSTRUCTIONS

PULL ACTIVATION PINS RIGHT BEFORE ENCLOSING WALL